

**ASSEMBLY INSTRUCTIONS
MONTAGEANLEITUNG
INSTRUCTION DE MONTAGE
MONTAGEAANWIJZING**

Welcome to the BACKFORCE community!

With your purchase, you do not only support us, but also your back! A true win-win situation.

We designed our chair with a long lifespan in mind. Reach us at info@backforce.gg if you need support!

We'd love to see how your new chair fits into your setup! Make sure to tag us if you post it to social media, so we can see it.

Kind regards

Your BACKFORCE Team

Interstuhl Büromöbel GmbH & Co. KG
Brühlstraße 21
72469 Meßstetten-Tieringen, Germany
Phone +49 7436 871-0
info@backforce.gg
www.backforce.gg

BACKFORCE - a brand of Interstuhl Group

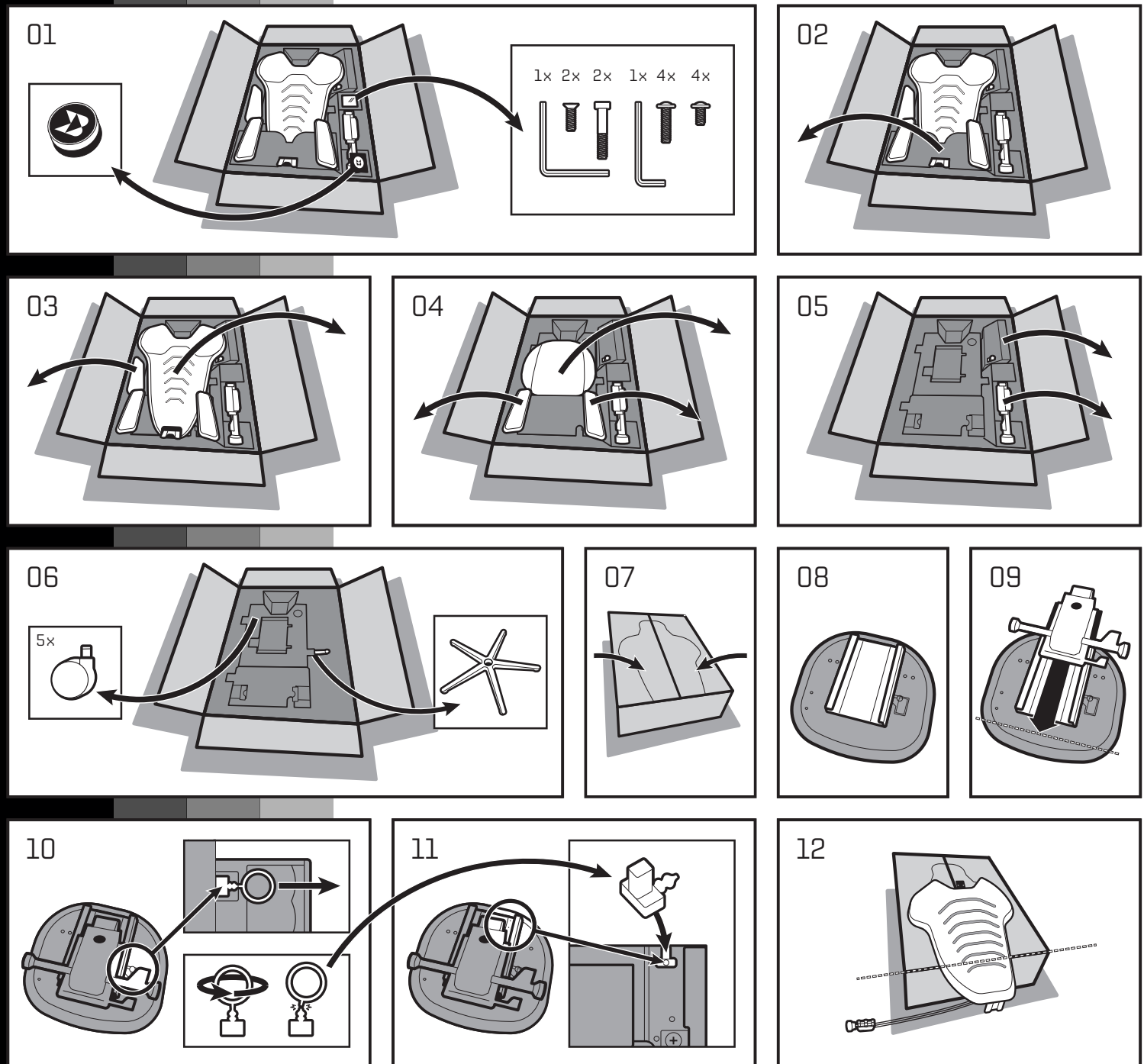

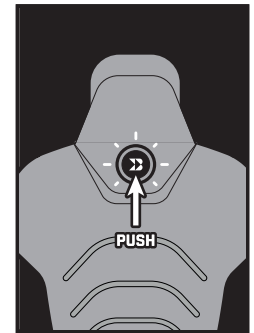
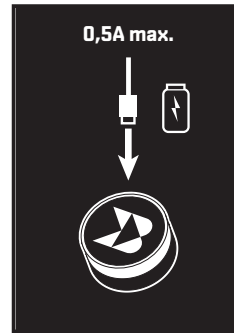
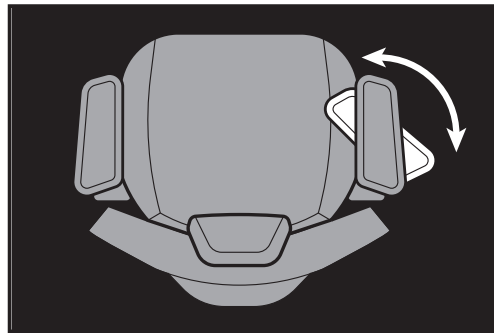
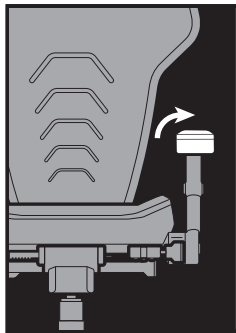
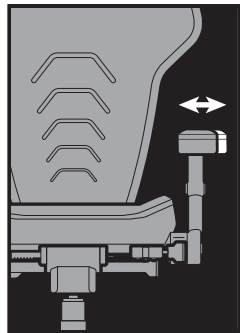
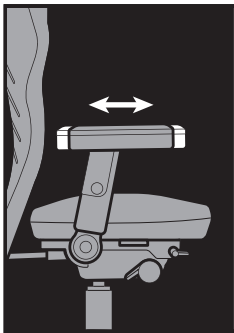
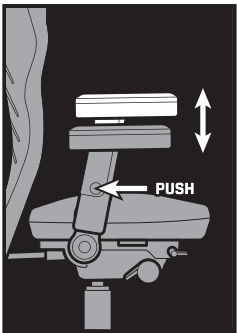
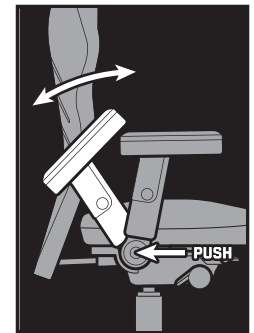
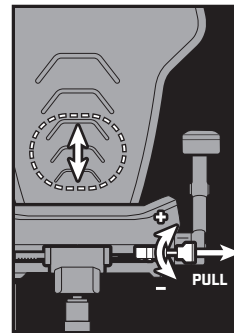
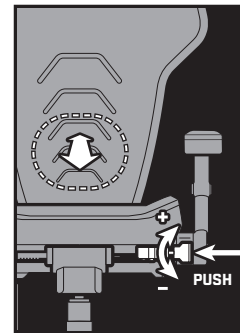
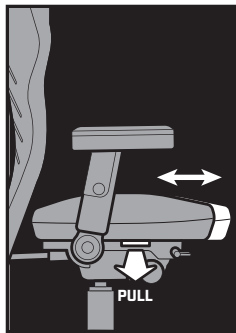
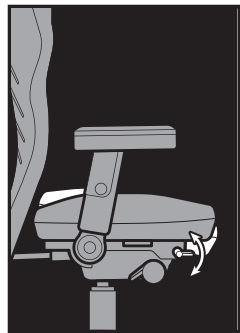
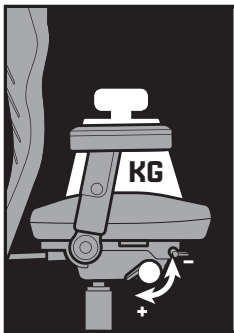
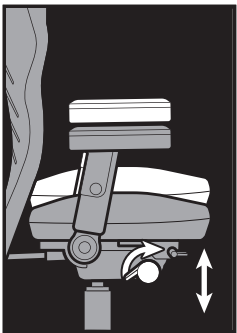
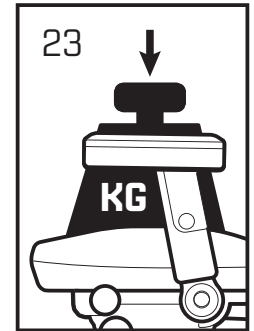
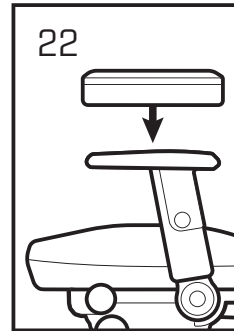
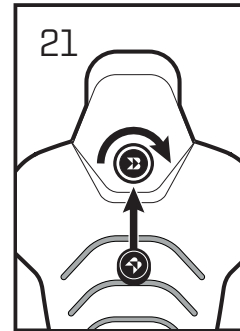
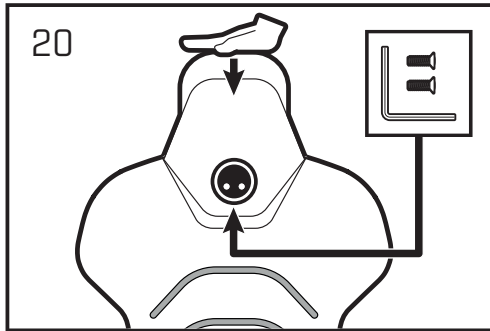
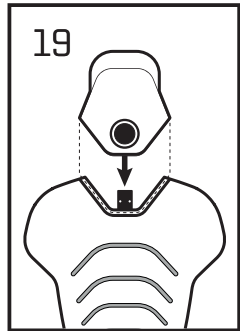
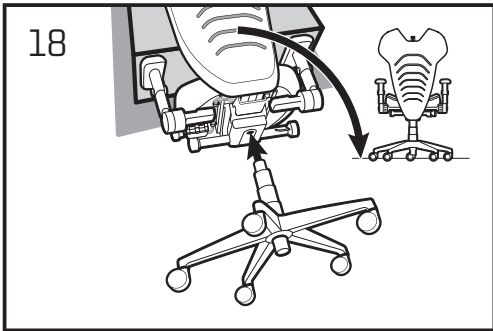
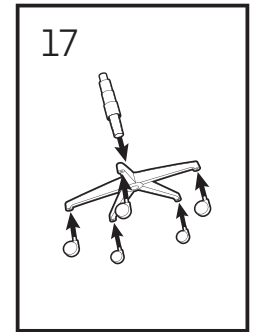
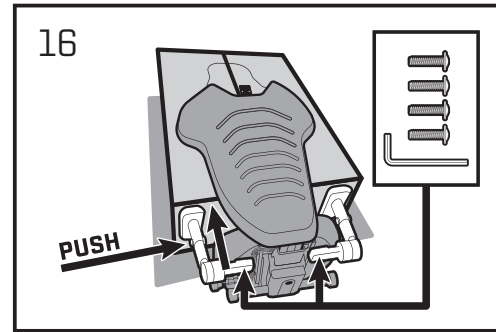
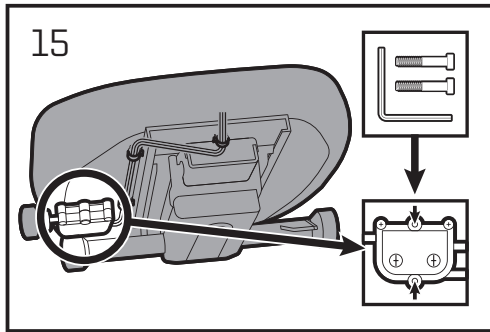
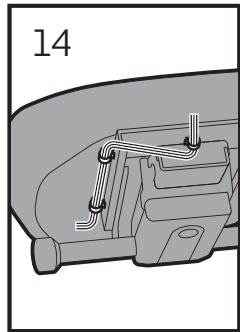
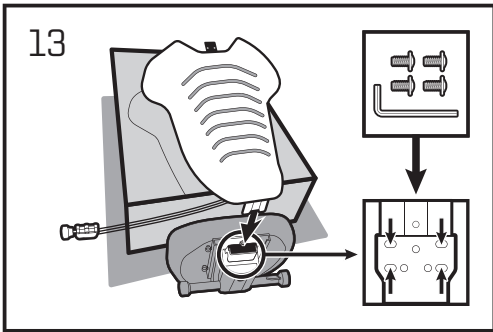

EN The manufacturer is not liable for damages due to improper use or negligence of maintenance. The GS-Certificate proves that office chairs are able to carry the body weight of 150 kilo gram. Only trained, specialized staff may be allowed to replace or carry out work on the gas spring. DE Der Hersteller haftet nicht für Schäden aus unsachgemäßem Gebrauch oder aus Nachlässigkeiten in der Wartung. Im Rahmen des GS-Zeichens werden Bürostühle mit einer Belastung, die 150 kg Körpergewicht entspricht, geprüft. Der Austausch bzw. das Arbeiten an der Gasfeder ist nur durch geschultes Fachpersonal durchzuführen. FR Le fabricant n'est pas responsable de dommages résultant d'une utilisation non conforme du produit et de dommages résultant d'opérations de maintenance. Dans le cadre du Certificat GS, les sièges de bureau supportent une charge de 150 kg. Tout changement ou tous travaux sur le vérin ne doivent être effectués que par du personnel spécialisé et qualifié. NL De fabricant is niet aansprakelijk voor schade die ontstaan door oneigenlijk gebruik of nalatigheid in het onderhoud. Conform het GS-certificaat [gecontroleerde veiligheid] worden kantoordraistoelen getest met een belasting die overeenkomt met 150 kg lichaamsgewicht. Alleen daarvoor opgeleide vakmensen mogen de gasveer vervangen resp. werkzaamheden aan de gasveer verrichten.